

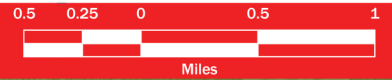

Ripley (W)

T.42N - R.32W



© 2008-Morrison County

Crow Wing County

See Cushing (E) Page 18

See Green Prairie (N) Page 24

See Ripley (E) Page 40

See Green Prairie (N) Page 24

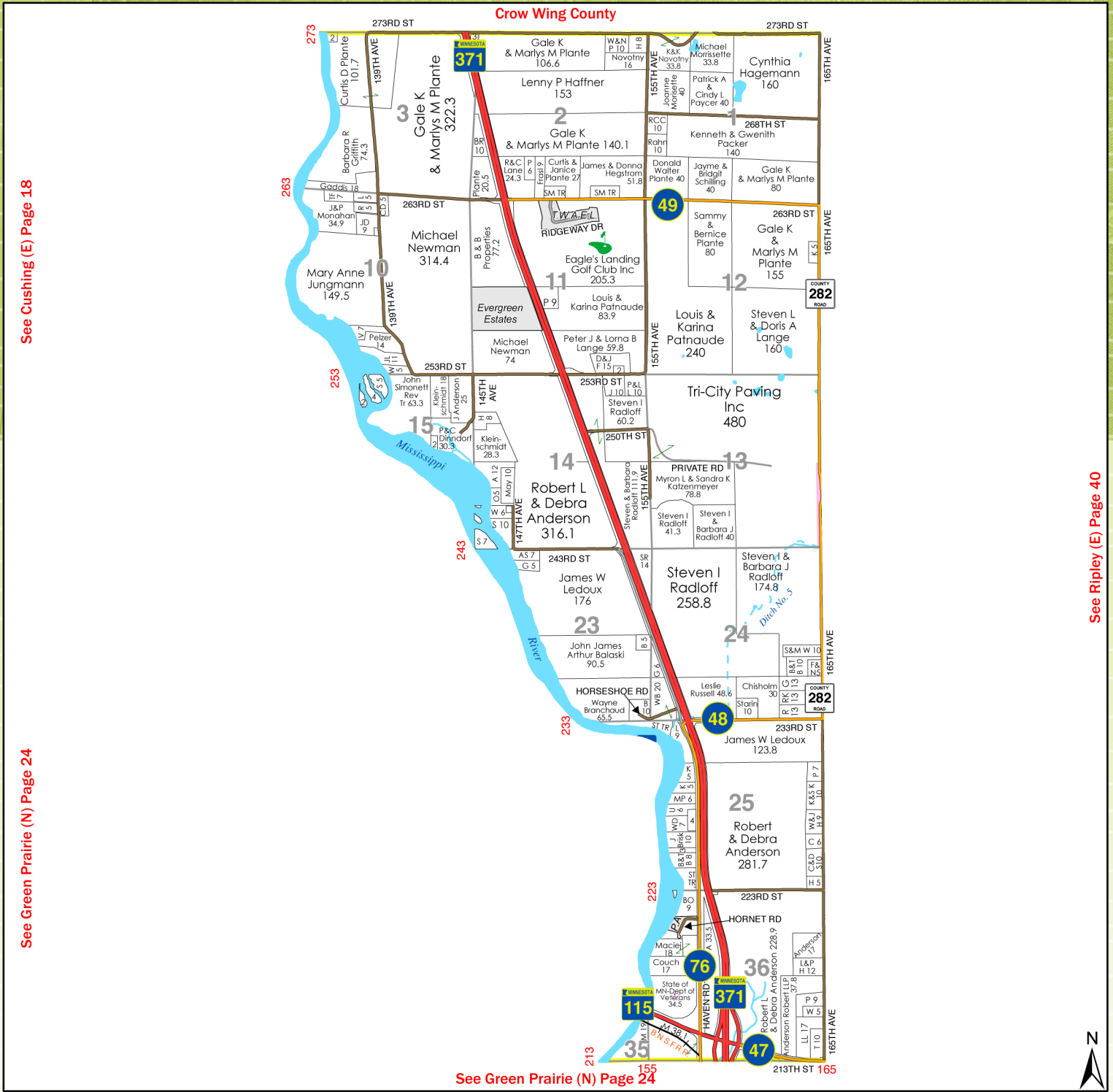

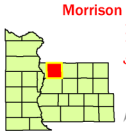

Ripley (E)

T.42N - R.31W



© 2008-Morrison County

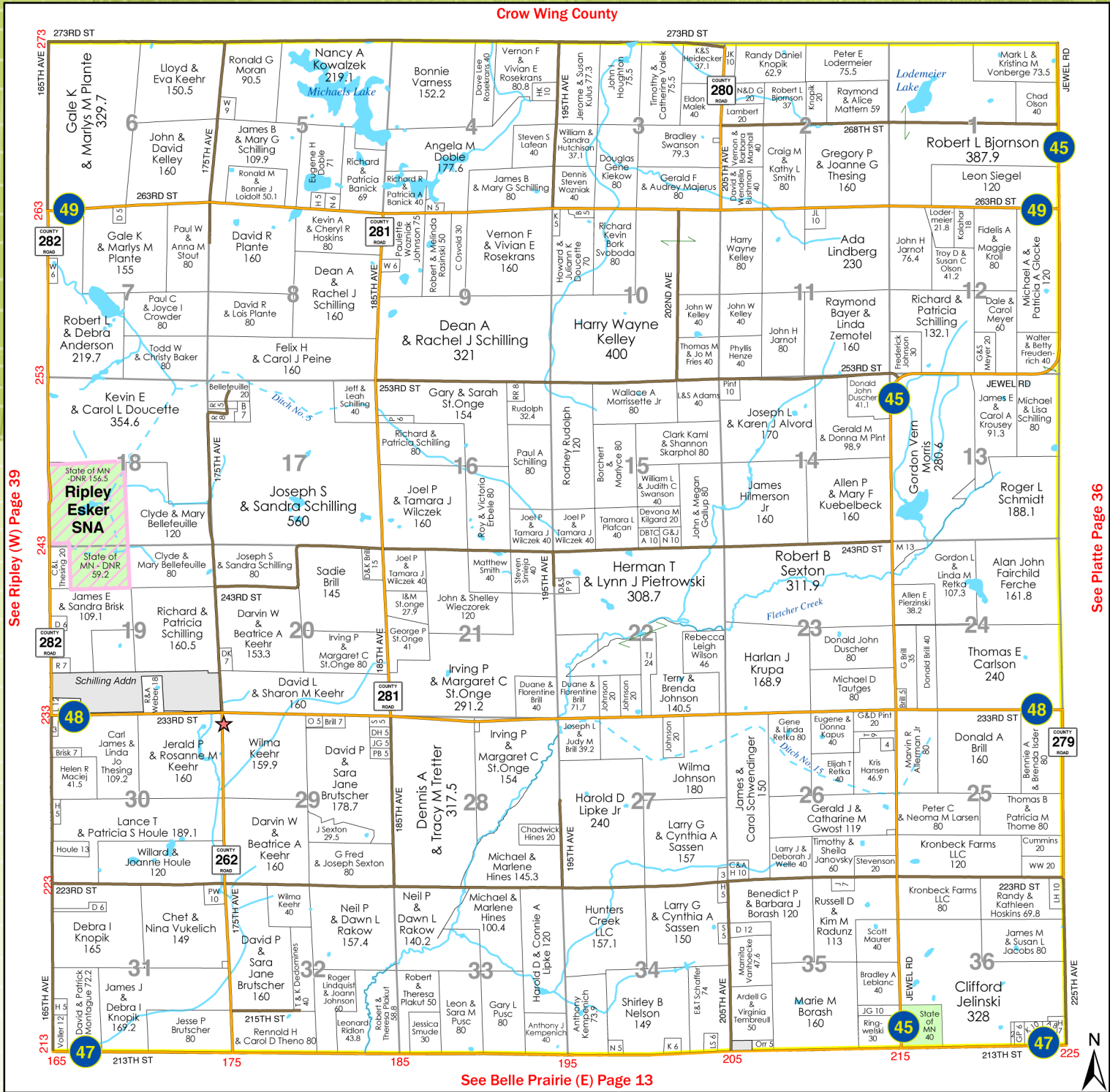

See Ripley (W) Page 39

See Platte Page 36

See Belle Prairie (E) Page 13

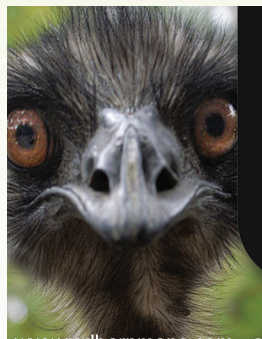

IT'S not too LATE!
 Still purchase advertising space!
 We print in small batches, you can get in the next printing of this book
At a discount!



www.redbarnmaps.com • advertise@redbarnmaps.com
 906.346.2276 • Fax: 906.346.2301